

Construction staff and operatives must ensure the principal contractor has provided thorough and accurate information on all health and safety aspects relating to the designs identified on this drawing including the review of:

- Designers/contractors risk assessments
- Method statements
- Permit to work
- Pre construction information

The designers note that the following health and safety risks relating to this drawing have not been eliminated during the design process:

ref	residual risk

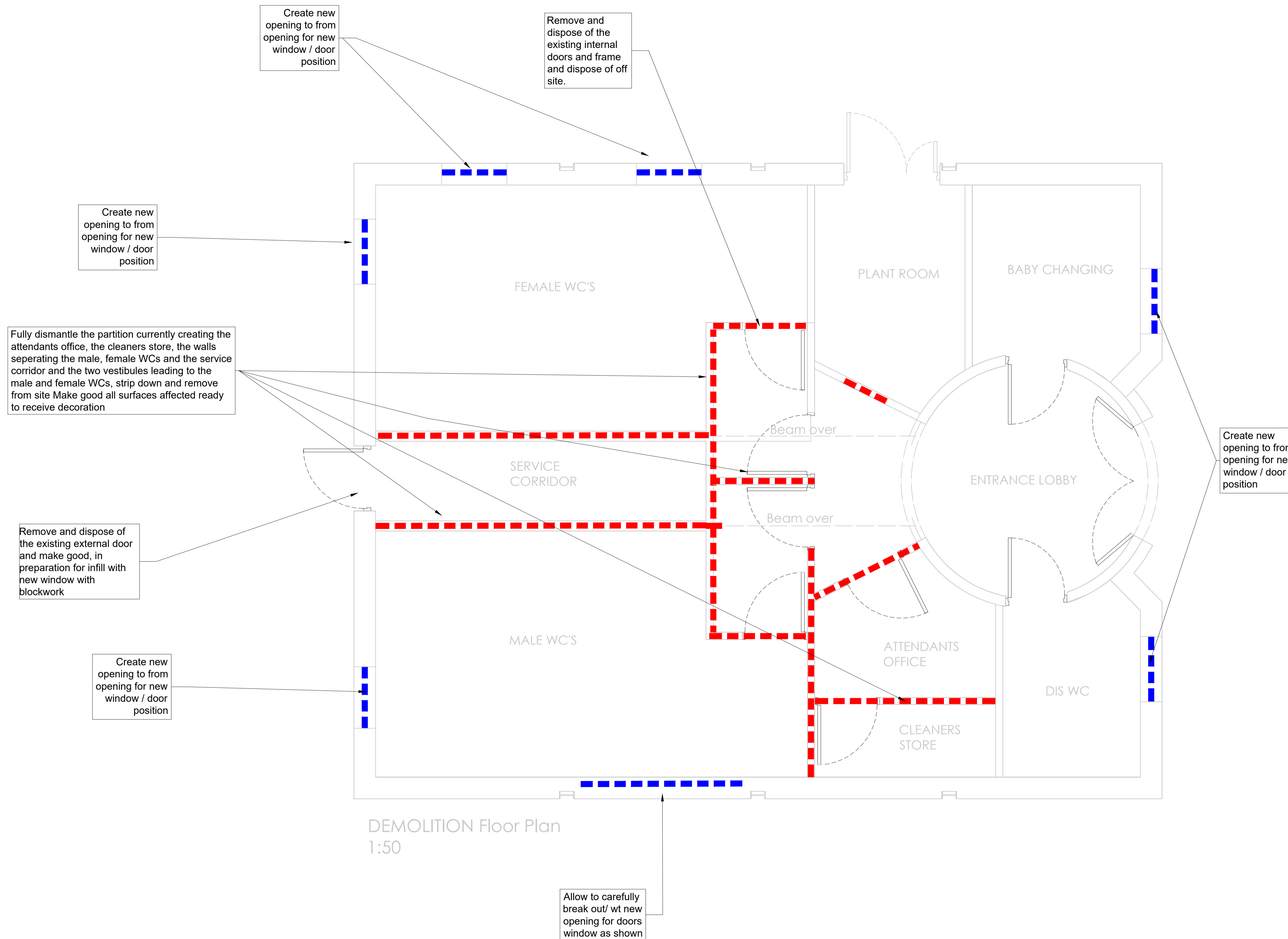

WALL FINISHES

- Fully dismantle the partition currently creating the attendants office, the cleaners store, the walls separating the male, female WCs and the service corridor and the two vestibules leading to the male and female WCs, strip down and remove from site, remove and dispose of the existing internal doors and frame and dispose of off site. Make good all surfaces affected ready to receive decoration.
- New opening to be created to accommodate new windows
- Existing opening to be infilled. Infill to be finished to tie in with existing surrounding walls.
- Construct new stud partition walling
- Existing wall finish to be made good where required. Walls to be dot dab plasterboard with skim finish. Decorated, 2No. mist coat and 2No. top coats Colour Light Gray RAL7035. To achieve uniform coverage and finish.
- Existing wall finish to be made good where required. Walls to be re-decorated, 2No. mist coat and 2No. top coats. Colour Light Gray RAL7035. To achieve uniform coverage and finish.
- New sliding / folding partition to be installed.

revision	date	by	chk
A Wall finish to common room	04/03/19	CM	

All dimensions to be verified on site and the Architect informed of any discrepancy. All drawings and specifications should be read in conjunction with the Health and Safety Plan; all conflicts should be reported to the appointed Principal Designer.

This drawing is the Property of Bowman Riley Architects Limited ©
DO NOT SCALE FROM THIS DRAWING

- preliminary
- comment
- construction
- planning
- tender
- record



Wellington House, Otley St, Skipton, N Yorkshire, BD23 1EL
Leeds | London | Skipton
01756 795611 www.bowmanriley.com

BINGLEY TOWN COUNCIL			
drawn by	checked by	date	scale @ A1
RS	DG	JUNE 2019	1:30
PUBLIC TOILETS, MYRTLE PLACE BINGLEY			
Demolition Plans			
project number	drawing number	revision	
2043	SK06	A	

Common Room Section A-A
Scale - 1:30

cad reference: U:_P-S\2043 - Bingley Toilets - PM\2043 - Project Files\Design and Specification\Myrtle Place Bingley construction.dwg